

# **Handbook for the Palm™ Portable Keyboard**

## Copyright

Copyright © 1999 Palm Computing, Inc. or its subsidiaries. All rights reserved. HotSync and Palm Computing are registered trademarks, and Palm, Palm III, Palm V, Palm VII, and PalmPilot are trademarks of Palm Computing, Inc. or its subsidiaries. Other product and brand names may be trademarks or registered trademarks of their respective owners.

## Disclaimer

Palm Computing, Inc. and its subsidiaries assume no responsibility for any damage or loss resulting from the use of this handbook.

Palm Computing, Inc. and its subsidiaries assume no responsibility for any loss or claims by third parties which may arise through the use of this product. Palm Computing, Inc., and its subsidiaries assume no responsibility for any damage or loss caused by deletion of data as a result of malfunction, dead battery, or repairs. Be sure to make backup copies of all important data on other media to protect against data loss.

# Contents

|   |           |
|---|-----------|
| <b>Introducing the Palm™ Portable Keyboard.....</b>     | <b>1</b>  |
| <b>Installing the Application.....</b>                  | <b>2</b>  |
| <b>Setting Up the Keyboard.....</b>                     | <b>4</b>  |
| <b>Closing the Keyboard .....</b>                       | <b>7</b>  |
| <b>Customizing Your Keyboard .....</b>                  | <b>9</b>  |
| Changing General settings.....                          | 9         |
| Assigning applications to command key combinations..... | 10        |
| Viewing keyboard shortcuts.....                         | 11        |
| <b>Keyboard Shortcuts .....</b>                         | <b>12</b> |
| Cursor movements.....                                   | 12        |
| Button shortcuts.....                                   | 13        |
| Menu commands .....                                     | 13        |
| Extended character set.....                             | 14        |
| Calculator functions.....                               | 16        |
| <b>Frequently Asked Questions .....</b>                 | <b>17</b> |
| <b>Warranty and Other Product Information.....</b>      | <b>19</b> |



# Introducing the Palm™ Portable Keyboard

The Palm™ Portable Keyboard is the convenient, portable solution for typing text and commands quickly and easily into your Palm Computing® organizer. This compact and fully functional keyboard enables you to do the following:

- Type text and special characters into your Palm applications
- Quickly access your main applications with keyboard buttons
- Enter commands and options with function keys
- Travel anywhere with a keyboard for your organizer

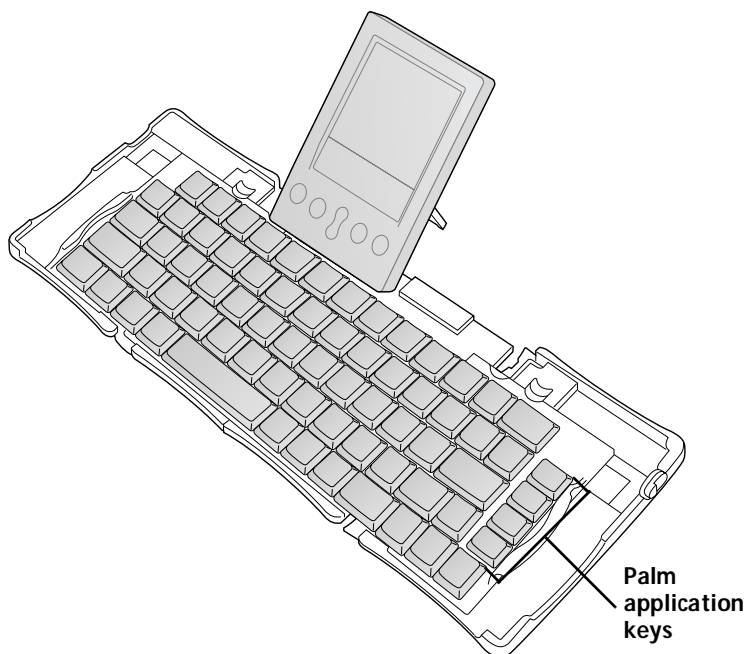

Before you can use your keyboard, you must do the following:

- Install the Palm Portable Keyboard application on your organizer
- Set up the keyboard and attach your Palm Computing organizer

# Installing the Application

Before you install the Palm™ Portable Keyboard application on your organizer, it's a good idea to perform a HotSync® operation to back up your data.

The application for the Palm Portable Keyboard controls the way the portable keyboard interacts with your organizer. It's a PRC file like most other applications for your organizer, and you install Keyboard.prc just like any other application.

**Note:** To use the keyboard with a PalmPilot™ Personal or Professional organizer, you cannot use the PRC included on the CD-ROM. Instead, download the version of Keyboard.prc from the following web site: <http://www.palm.com/custsupp/downloads>

## To load the keyboard application on Windows 95/98:

1. Insert the CD-ROM into the CD-ROM drive, and then double-click the CD-ROM drive icon.
2. Copy the Keyboard.prc file from the CD-ROM drive to the Add-on folder in your Palm™ Desktop directory.
3. Click Start in the Windows taskbar.
4. Choose Programs, and then choose Palm Desktop.
5. Choose Install Tool.
6. In the User drop-down list, select the name that corresponds to your organizer.
7. Click Add.
8. Select Keyboard.prc from the list of applications, and then click Open.
9. Click Done.
10. Click OK.

## To load the keyboard application on Macintosh:

1. Exit any open programs, including those in the Startup folder, and disable any virus-scanning software.
2. Insert the CD-ROM into the CD-ROM drive.
3. When the folder appears on the desktop, drag the Keyboard.prc file into the Add-on folder in the Palm folder.

4. Double-click the HotSync Manager icon in the Palm folder.
5. Choose Install from the HotSync menu.
6. Drag Keyboard.prc to the Install Handheld Files dialog box.

**To install the keyboard application on your organizer:**

- Perform a HotSync operation to install the application on your organizer.

The icon for the Palm Portable Keyboard application appears in the Applications Launcher.



**Icon of the Palm Portable Keyboard application**

Now you're ready to set up your keyboard.

# Setting Up the Keyboard

Always use your keyboard on a hard, flat surface.

**To open the keyboard:**

1. Hold the keyboard in your hands and slide the latch down to open the case.

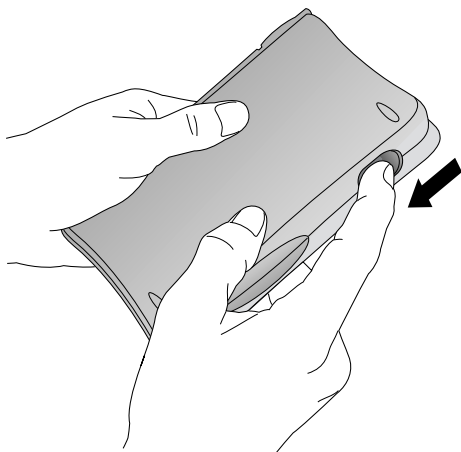

2. Unfold the keyboard and place it on a hard, flat surface.

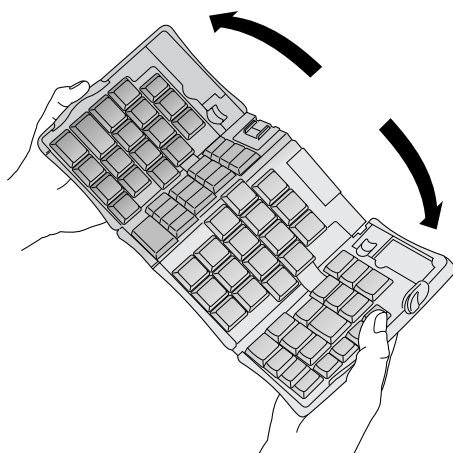



3. Grasp the two side-grips (with red borders) and slide them in toward the keyboard's center until the keyboard sections are completely together.

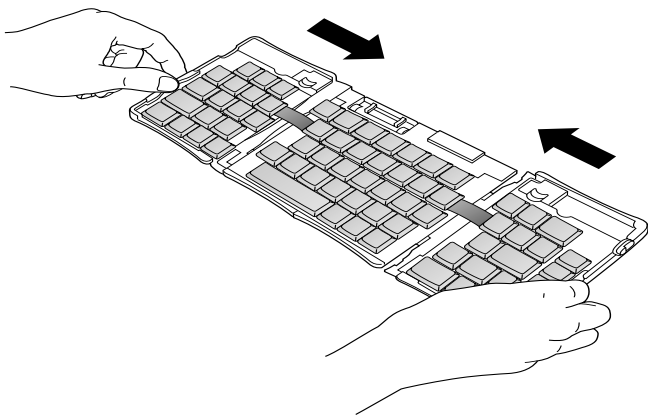

4. While holding the keyboard, slide the docking connector support bracket out until it clicks; then tilt it up and push the flat support outward.

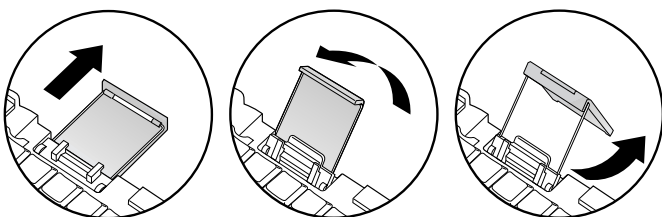

**To connect your organizer:**

1. Line up your organizer with the angle of the support bracket.
2. Slide your organizer securely onto the keyboard docking connector. Your organizer turns on automatically.

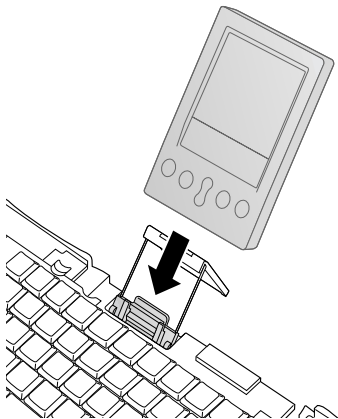

After you install the keyboard application and connect the organizer, you can begin typing.

# Closing the Keyboard

When you finish using your keyboard, remove the organizer, unlock and fold up the keyboard, and close it back into a portable case.

1. Pull your organizer up and away from the docking connector.
2. Fold the docking connector support bracket in and down flat; then slide it back into the keyboard.
3. With your thumbs, slide the side-grips to the outside of the keyboard. Make sure the two outer keyboard sections are as far apart as possible.

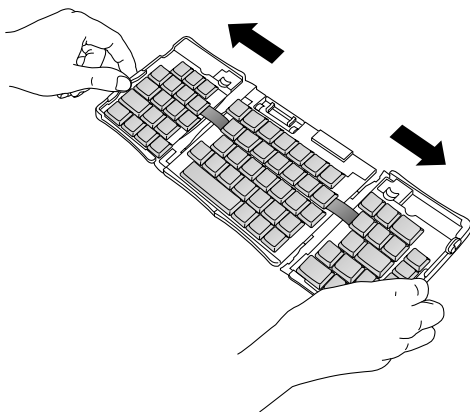

4. Fold the center section upward, and bring the left and right sides together. The keyboard now forms a “W.”

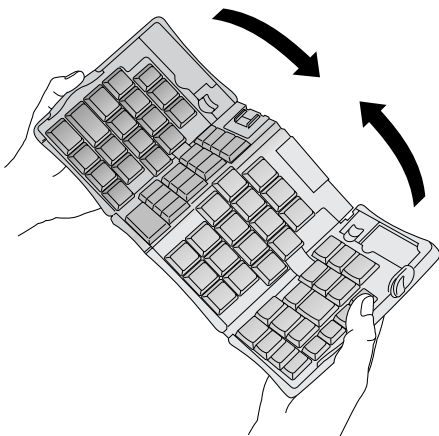

5. Continue to fold the keyboard shut. Press the two sides of the case together, and then snap all four corners shut. You feel a click at all four corners.

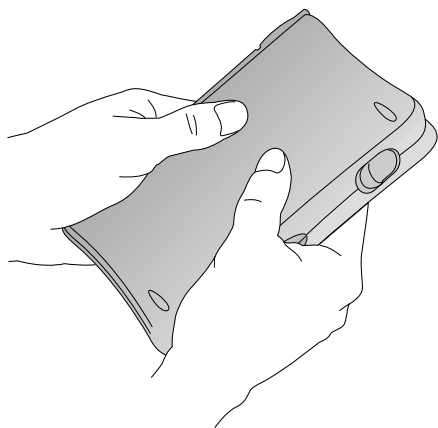



# Customizing Your Keyboard

You can customize your keyboard using the options available in the keyboard application on your organizer.

## Changing General settings

The General settings control the interaction of the keyboard with the organizer.

To change General settings:

1. Tap the Applications icon .
2. Tap the Keyboard icon .
3. Change the settings.



**Key Repeat Rate:** Drag the indicator to speed up or slow down the rate at which a character is typed when you hold down the key.

**Delay Until Repeat:** Drag the indicator to lengthen or shorten the time between typing the first key to repeat and the appearance of the subsequent repeated keys.

**Test Repeat Settings:** Hold down a key in this edit line to test your selections for Key Repeat Rate and Delay Until Repeat.

**Enable key clicks:** Tap in order to hear a click when you press a key. The System Sound option in the General Preferences for your organizer must also be set to Low, Medium, or High.



**Enable keyboard:** Tap to turn the keyboard driver off and on. The default setting is on (selected).

# Assigning applications to command key combinations

You can open the main organizer applications — Date Book, Address Book, To Do List, and Memo Pad — using the four keys on the far right of your portable keyboard.

You can also open an application by using a command key combination that you assign to it.

To assign an application to a command key combination:

1. Tap the Applications icon .
2. Tap the Keyboard icon .
3. Tap the pick list in the upper-right corner of the screen and select Cmd Keys.

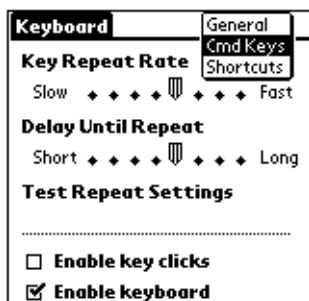

4. Tap the pick list of the command key combination that you want to assign to an application.
5. Select the application that you want to assign to the key combination.

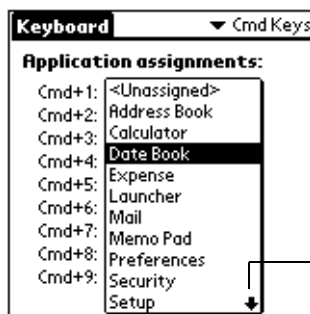



Tap an arrow to move through the list a page at a time

# Viewing keyboard shortcuts

Your keyboard comes with a full set of keyboard shortcuts for performing organizer functions. Use the Shortcuts list to view the available shortcuts.

To view the list of keyboard shortcuts:

1. Tap the Applications icon .
2. Tap the Keyboard icon .
3. Tap the pick list in the upper-right corner and select Shortcuts.



4. Use the onscreen scroll bar or the scroll button on the front panel of your organizer to move through the list.

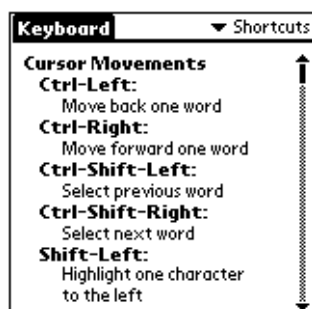

See “Keyboard Shortcuts” for the keyboard shortcuts that appear in the list on your organizer.

# Keyboard Shortcuts

This section lists the keyboard shortcuts that are available on your portable keyboard.

## Cursor movements

This table lists the shortcuts for moving the cursor and selecting text.

| Shortcut                   | Action                                       |
|----------------------------|--|
| Ctrl - Left arrow          | Moves cursor left (back) one word            |
| Ctrl - Right arrow         | Moves cursor right (forward) one word        |
| Ctrl - Shift - Left arrow  | Selects previous word                        |
| Ctrl - Shift - Right arrow | Selects next word                            |
| Shift - Left arrow         | Selects character to the left of the cursor  |
| Shift - Right arrow        | Selects character to the right of the cursor |
| Shift - Up arrow           | Selects previous line                        |
| Shift - Down arrow         | Selects next line                            |
| Cmd - Left arrow           | Moves cursor to the beginning of the line    |
| Cmd - Right arrow          | Moves cursor to the end of the line          |
| Fn - Up arrow              | Scrolls up                                   |
| Fn - Down arrow            | Scrolls down                                 |
| Tab                        | Tabs forward through edit lines              |
| Shift - Tab                | Tabs backward through edit lines             |
| Fn - Tab                   | Inserts a tab in a line                      |



## Button shortcuts

This table lists the key combinations to activate onscreen buttons.

**Note:** You can also activate a button by pressing Ctrl - Cmd and a letter unique to the button name.

| Keystroke        | Equivalent onscreen button |
|------------------|----------------------------|
| Fn - Enter       | OK                         |
| Fn - Del         | Delete                     |
| Fn - Done        | Cancel                     |
| Fn - New         | New                        |
| Fn - Left arrow  | Show                       |
| Fn - Right arrow | Details                    |
| Fn - ,           | Note                       |
| Fn - /           | Edit                       |

## Menu commands

This table lists the key combinations to activate organizer commands.

| Keystroke | Action                                       |
|-----------|--|
| Ctrl - x  | Cuts selected text                           |
| Ctrl - c  | Copies selected text                         |
| Ctrl - v  | Pastes cut or copied text                    |
| Fn - Cmd  | Enters shortcut mode                         |
| Fn - =    | Toggles backlight                            |
| Cmd-space | Enters kana mode ( <i>Japanese OS only</i> ) |

# Extended character set

The following two tables list the function key and character combinations to generate extended characters.

**Table 1: Accent marks**

First, type the letter to which you want to add an accent. Then quickly press the function key and the character indicated.

For example, to type the ö in Köln, type the o, and then quickly press Fn and ; (function key and semicolon). The umlaut appears over the o.

| Keystroke | Character example | Description                  |
|-----------|-------------------|------------------------------|
| Fn - '    | á                 | Acute accent                 |
| Fn - ^    | â                 | Circumflex                   |
| Fn - ;    | ä                 | Umlaut                       |
| Fn - `    | à                 | Grave accent                 |
| Fn - ~    | ã                 | Tilde                        |
| Fn - o    | å                 | Aring (with letter “a” only) |

See “Does the keyboard support international characters?” later in this book to learn how to use the Alt key to make the portable keyboard mimic the onscreen international keyboard on your organizer.

**Table 2: Characters, symbols, punctuation marks**

| Keystroke | Character example | Description           |
|-----------|-------------------|-----------------------|
| Fn - O    | Ø                 | Uppercase Oslash      |
| Fn - o    | ø                 | Lowercase oslash      |
| Fn - ?    | ¿                 | Upside down “?”       |
| Fn - !    | ¡                 | Upside down “!”       |
| Fn - A    | Æ                 | Uppercase AE ligature |
| Fn - a    | æ                 | Lowercase ae ligature |
| Fn - b    | β                 | Beta                  |

|               |          |                          |
|---------------|----------|--------------------------|
| Fn - w        | ■        | Bullet                   |
| Fn - c        | ¸        | Cedilla                  |
| Fn - g        | ©        | Copyright                |
| Fn - d        | °        | Degrees                  |
| Fn - <hyphen> | ÷        | Divide                   |
| Fn - u        | μ        | Micro                    |
| Fn - \        | ¶        | Paragraph symbol         |
| Fn - p        | £        | Pound sterling           |
| Fn - r        | ®        | Registered trademark     |
| Fn - s        | §        | Section                  |
| Fn - t        | ™        | Trademark                |
| Fn - y        | ¥        | Japanese yen             |
| Fn - +        | ±        | Plus/minus               |
| Fn - 2        | 1/2      | Half                     |
| Fn - 3        | 3/4      | Three-quarters           |
| Fn - 4        | 1/4      | One-quarter              |
| Fn - \$       | ¢        | Cents                    |
| Fn - f        | <i>f</i> | Script f                 |
| Fn - [        | ‘        | Left single curly quote  |
| Fn - ]        | ’        | Right single curly quote |
| Fn - {        | “        | Left double curly quote  |
| Fn - }        | ”        | Right double curly quote |

# Calculator functions

This table lists keystrokes to activate calculator functions.

| Keystroke | Action                                  |
|-----------|---|
| + - * / = | Add, subtract, multiply, divide, equals |
| C         | Clear all                               |
| E         | Clear last entry                        |
| M         | Clear memory                            |
| P         | Set current number on display in memory |
| R         | Recall value in memory                  |

# Frequently Asked Questions

If you encounter a problem with your keyboard, first review both “General questions and answers” below and the following sources:

- The readme file on the CD-ROM for your Palm™ Portable Keyboard.
- The web site <http://www.palm.com/custsupp/keyboard> for the latest FAQ and/or Troubleshooting guide for the keyboard.

If you are still having problems, contact Technical Support. For US and International telephone numbers, see the Worldwide Customer Support card that comes with your keyboard. International support numbers are also available in the International page of this web site: <http://www.palm.com>

## General questions and answers

### Does the keyboard require batteries?

No. The keyboard is designed to use an extremely low amount of power from your organizer.

### Can I use the same keyboard for all organizers?

No. The keyboard is available in two versions, one for the Palm III™ organizer and the other for the Palm V™ organizer. The keyboard for the Palm III organizer supports the PalmPilot™ Personal and Professional organizers, the Palm III series, and the Palm VII™ series.

**Note:** If you want to use the portable keyboard with a PalmPilot Personal or Professional organizer, you must install a different version of Keyboard.prc. You can download it from this web site: <http://www.palm.com/custsupp/downloads>

### Can I perform a HotSync® operation on the organizer while using the keyboard?

No. The keyboard does not replace the functionality of your cradle. To perform a HotSync operation after entering data with the keyboard, remove your organizer from the keyboard and place it in your cradle. Then press the HotSync button.

**Does the keyboard support international characters?**

Yes. You can enter international characters in two ways:

Use keyboard shortcuts: Use the function key (Fn) in combination with another key to add accent marks to letters you type, and to type punctuation marks. See “Extended character set” earlier in this book.

For example, to type the ö in Köln, type the o, and then press Fn and ; (function key and semicolon). The umlaut appears over the o.

Use the Alt key on the portable keyboard: When you press and hold down the Alt key, the next key you press produces the character corresponding to that location on your organizer’s onscreen international keyboard.

For example, to type the ö in Köln, press and hold down Alt; then press c on your portable keyboard.

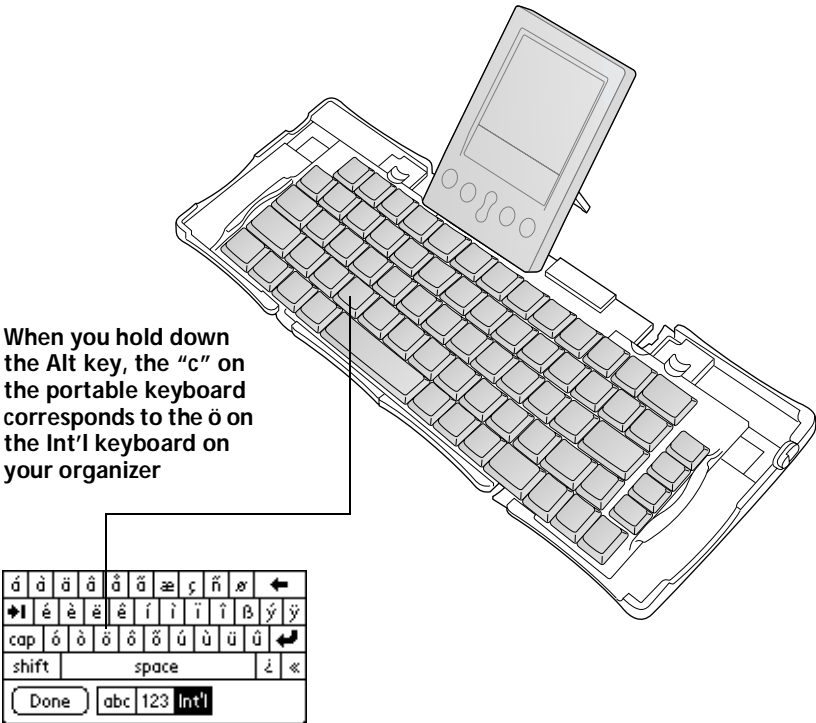

# Warranty and Other Product Information

## Limited warranty

**HARDWARE:** Palm Computing, Inc. ("Palm Computing"), warrants to the original end user ("Customer") that this product will be free from defects in workmanship and materials, under normal use, for one year from the date of original purchase from Palm Computing or its authorized reseller. Palm Computing's sole obligation under this express warranty shall be, at Palm Computing's option and expense, to replace the product or part with a comparable product or part, repair the product or part, or if neither repair nor replacement is reasonably available, Palm Computing may, in its sole discretion, refund to Customer the purchase price paid for the product or part. Replacement products or parts may be new or reconditioned. Palm Computing warrants any replaced or repaired product or part, and any hardware upgrade to which Customer is entitled under an agreement between Customer and Palm Computing, for a period of ninety (90) days from shipment, or through the end of the original warranty, whichever is longer. All products or parts that are replaced become the property of Palm Computing.

Accessory products, as listed in the applicable Palm Computing catalogue, are not covered under this Limited Warranty except for the modems for the connected organizer, the cradles, cables, memory upgrades, keyboards, styli, and leather items sold under the Palm Computing® brand. Palm Computing shall not be responsible for Customer's software, firmware, information, or memory data contained in, stored on, or integrated with any products returned to Palm Computing for repair, whether under warranty or not.

**SOFTWARE:** Palm Computing warrants to Customer that the Palm™ Desktop organizer software and Palm OS® software licensed from it will perform in substantial conformance to their program specifications, for a period of ninety (90) days from the date of original purchase from Palm Computing or its authorized reseller. Palm Computing warrants the media containing software against failure during the warranty period. No updates are provided. Palm Computing does not provide any warranty for Adobe® Acrobat® Reader or any other third-party applications software that is licensed to Customer by the third party. Palm Computing's sole obligation with respect to this express warranty shall be (at Palm Computing's discretion) to refund the purchase price paid by Customer for any defective software product, or to replace any defective media with software which substantially conforms to applicable Palm Computing published specifications. Palm Computing makes no warranty or representation that its software products will meet Customer's requirements or will work in combination with any hardware or applications software products provided by third parties, that the operation of the software products will be uninterrupted or error free, or that all defects in the software products will be corrected.

THIS PALM COMPUTING PRODUCT MAY INCLUDE OR BE BUNDLED WITH THIRD PARTY SOFTWARE, THE USE OF WHICH IS GOVERNED BY A SEPARATE END USER LICENSE AGREEMENT. THIS PALM COMPUTING WARRANTY DOES NOT APPLY TO SUCH THIRD PARTY SOFTWARE. FOR THE APPLICABLE WARRANTY, PLEASE REFER TO THE END USER LICENSE AGREEMENT GOVERNING THE USE OF SUCH SOFTWARE OR THE ACCOMPANYING DOCUMENTATION RELATING TO SUCH SOFTWARE.

**YEAR 2000 WARRANTY:** In addition to the Hardware Warranty and Software Warranty stated above, Palm Computing warrants that the following date-data sensitive Palm Computing products, namely the Pilot 1000, Pilot 5000, PalmPilot™ Personal Edition, PalmPilot Professional Edition, Palm III™ series, Palm V™ series, and Palm VII™ series connected organizers, as well as all other Palm Computing products based on the Palm Computing platform software as of July 1, 1998 and later, including the companion desktop software for Microsoft® Windows® and MAC OS™ platforms, will continue performing properly with regard to such date-data on and after January 1, 2000, provided that all other products used by Customer in connection or combination with the Palm Computing product, including hardware, software, and firmware, accurately exchange date-data with the Palm Computing product. Palm Computing makes no certification regarding the Year 2000 status of any other Palm Computing products.

Any Palm Computing platform application supplied by Palm Computing that makes correct use of Palm Computing platform date and time functions will not have a problem transitioning to the year 2000. The date and time utilities for the Palm Computing platform use 32 bits to store seconds, starting at January 1, 1904. This approach allows the correct representation of dates through February 5, 2040. The Date Book software currently displays dates through December 31, 2031. Provided the product is still being sold by Palm Computing, Palm Computing will make software enhancements to remove these limitations well in advance of these dates.

If it appears that any Palm Computing product does not perform properly with regard to such date-data on and after January 1, 2000, and Customer notifies Palm Computing before the later of April 1, 2000, or ninety (90) days after original purchase of the product from Palm Computing or its authorized reseller, Palm Computing shall, at its option and expense, provide a software update which would effect the proper performance of the product, repair the product, deliver to Customer an equivalent product to replace the product, or, if none of the foregoing is feasible, refund to Customer the purchase price paid for the product.

Any software update or replaced or repaired Palm Computing product will carry a Year 2000 Limited Warranty for ninety (90) days after purchase or until April 1, 2000, whichever is later.

Customers using date and time utilities other than those supplied by Palm Computing should check with the developer to determine if the software will correctly handle all of the subtle issues of date and time conversion.

**OBTAINING WARRANTY SERVICE:** Customer must contact a Palm Computing Technical Support or Customer Service center within the applicable warranty period to obtain warranty service authorization. Dated proof of original purchase from Palm Computing or its authorized reseller will be required. Palm Computing is not respon-



sible for Customer products or parts received without a warranty service authorization. In the United States, Palm Computing may ship a replacement product or part prior to receiving the original product or part ("advance exchange"). If advance exchange is not available, then the repaired product or part will be shipped as soon as reasonably possible, which will be no later than thirty (30) days after Palm Computing receives the original product or part. Repaired or replacement products will be shipped to Customer at Palm Computing's expense. The repair and replacement process for products or parts in locations outside of the United States will vary depending on Customer's location.

Products or parts shipped by Customer to Palm Computing must be sent prepaid and packaged appropriately for safe shipment, and it is recommended that they be insured or sent by a method that provides for tracking of the package. When an advance exchange is provided and Customer fails to return the original product or part to Palm Computing within thirty (30) days from the date the warranty service authorization is issued, Palm Computing will charge Customer the then-current published catalogue price of such product or part.

**WARRANTIES EXCLUSIVE:** IF THIS PRODUCT DOES NOT OPERATE AS WARRANTED ABOVE, CUSTOMER'S SOLE REMEDY FOR BREACH OF THAT WARRANTY SHALL BE REPLACEMENT OR REPAIR OF THE PRODUCT OR PART, OR REFUND OF THE PURCHASE PRICE PAID, AT PALM COMPUTING'S OPTION. TO THE FULL EXTENT ALLOWED BY LAW, THE FOREGOING WARRANTIES AND REMEDIES ARE EXCLUSIVE AND ARE IN LIEU OF ALL OTHER WARRANTIES, TERMS, OR CONDITIONS, EXPRESS OR IMPLIED, EITHER IN FACT OR BY OPERATION OF LAW, STATUTORY OR OTHERWISE, INCLUDING WARRANTIES, TERMS, OR CONDITIONS OF MERCHANTABILITY, FITNESS FOR A PARTICULAR PURPOSE, SATISFACTORY QUALITY, CORRESPONDENCE WITH DESCRIPTION, AND NON-INFRINGEMENT, ALL OF WHICH ARE EXPRESSLY DISCLAIMED. PALM COMPUTING NEITHER ASSUMES NOR AUTHORIZES ANY OTHER PERSON TO ASSUME FOR IT ANY OTHER LIABILITY IN CONNECTION WITH THE SALE, INSTALLATION, MAINTENANCE OR USE OF ITS PRODUCTS.

PALM COMPUTING SHALL NOT BE LIABLE UNDER THIS WARRANTY IF ITS TESTING AND EXAMINATION DISCLOSE THAT THE ALLEGED DEFECT OR MALFUNCTION IN THE PRODUCT DOES NOT EXIST OR WAS CAUSED BY CUSTOMER'S OR ANY THIRD PERSON'S MISUSE, NEGLIGENCE, IMPROPER INSTALLATION OR TESTING, UNAUTHORIZED ATTEMPTS TO OPEN, REPAIR, OR MODIFY THE PRODUCT, OR ANY OTHER CAUSE BEYOND THE RANGE OF THE INTENDED USE, OR BY ACCIDENT, FIRE, LIGHTNING, POWER CUTS OR OUTAGES, OTHER HAZARDS, OR ACTS OF GOD. THIS WARRANTY DOES NOT COVER PHYSICAL DAMAGE TO THE SURFACE OF THE PRODUCT, INCLUDING CRACKS OR SCRATCHES ON THE LCD TOUCHSCREEN OR OUTSIDE CASING. THIS WARRANTY DOES NOT APPLY WHEN THE MALFUNCTION RESULTS FROM THE USE OF THIS PRODUCT IN CONJUNCTION WITH ACCESSORIES, OTHER PRODUCTS, OR ANCILLARY OR PERIPHERAL EQUIPMENT AND PALM COMPUTING DETERMINES THAT THERE IS NO FAULT WITH THE PRODUCT ITSELF. THIS WARRANTY DOES NOT APPLY TO ANY MALFUNCTION OR FAILURE OF THE PRODUCT OR PART DUE TO ANY COMMUNICATION SERVICE CUSTOMER MAY SUBSCRIBE TO FOR USE WITH THE PRODUCT.

**LIMITATION OF LIABILITY:** TO THE FULL EXTENT ALLOWED BY LAW, PALM COMPUTING ALSO EXCLUDES FOR ITSELF AND ITS SUPPLIERS ANY LIABILITY, WHETHER BASED IN CONTRACT OR TORT (INCLUDING NEGLIGENCE), FOR INCIDENTAL, CONSEQUENTIAL, INDIRECT, SPECIAL, OR PUNITIVE DAMAGES OF ANY KIND, OR FOR LOSS OF REVENUE OR PROFITS, LOSS OF BUSINESS, LOSS OF INFORMATION OR DATA, OR OTHER FINANCIAL LOSS ARISING OUT OF OR IN CONNECTION WITH THE SALE, INSTALLATION, MAINTENANCE, USE, PERFORMANCE, FAILURE, OR INTERRUPTION OF THIS PRODUCT, EVEN IF PALM COMPUTING OR ITS AUTHORIZED RESELLER HAS BEEN ADVISED OF THE POSSIBILITY OF SUCH DAMAGES, AND LIMITS ITS LIABILITY TO REPLACEMENT, REPAIR, OR REFUND OF THE PURCHASE PRICE PAID, AT PALM COMPUTING'S OPTION. THIS DISCLAIMER OF LIABILITY FOR DAMAGES WILL NOT BE AFFECTED IF ANY REMEDY PROVIDED HEREIN SHALL FAIL OF ITS ESSENTIAL PURPOSE.

**DISCLAIMER:** Some countries, states, or provinces do not allow the exclusion or limitation of implied warranties or the limitation of incidental or consequential damages for certain products supplied to consumers, or the limitation of liability for personal injury, so the above limitations and exclusions may be limited in their application to you. When the implied warranties are not allowed to be excluded in their entirety, they will be limited to the duration of the applicable written warranty. This warranty gives you specific legal rights which may vary depending on local law.

**GOVERNING LAW:** This Limited Warranty shall be governed by the laws of the State of California, U.S.A., and by the laws of the United States, excluding their conflicts of laws principles. The United Nations Convention on Contracts for the International Sale of Goods is hereby excluded in its entirety from application to this Limited Warranty.

Palm Computing, Inc.  
5400 Bayfront Plaza  
PO Box 58007  
Santa Clara, California 95052-8007  
United States of America  
(408) 326-5000  
October 26, 1999

## End user software license agreement

YOU SHOULD CAREFULLY READ THE FOLLOWING TERMS AND CONDITIONS BEFORE USING THIS PRODUCT. IT CONTAINS SOFTWARE, THE USE OF WHICH IS LICENSED BY PALM COMPUTING, INC. ("PALM COMPUTING"), TO ITS CUSTOMERS FOR THEIR USE ONLY AS SET FORTH BELOW. IF YOU DO NOT AGREE TO THE TERMS AND CONDITIONS OF THIS AGREEMENT, DO NOT USE THE SOFTWARE. USING ANY PART OF THE SOFTWARE INDICATES THAT YOU ACCEPT THESE TERMS.

**LICENSE:** Palm Computing grants you a nonexclusive license to use the accompanying software program(s) (the "Software") subject to the terms and restrictions set forth in this License Agreement. You are not permitted to lease or rent (except under separate mutually agreeable terms set forth in writing), distribute or sublicense the Software or

to use the Software in a time-sharing arrangement or in any other unauthorized manner. Further, no license is granted to you in the human readable code of the Software (source code). Except as provided below, this License Agreement does not grant you any rights to patents, copyrights, trade secrets, trademarks, or any other rights in respect to the Software.

The Software is licensed to be used on any personal computer and/or any Palm Computing product, provided that the Software is used only in connection with Palm Computing products. With respect to the Desktop Software, you may reproduce and provide one (1) copy of such Software for each personal computer or Palm Computing product on which such Software is used as permitted hereunder. With respect to the Device Software, you may use such Software only on one (1) Palm Computing product. Otherwise, the Software and supporting documentation may be copied only as essential for backup or archive purposes in support of your use of the Software as permitted hereunder. You must reproduce and include all copyright notices and any other proprietary rights notices appearing on the Software on any copies that you make.

Notwithstanding any other provision of this License Agreement, this License Agreement shall not be deemed to apply to the Adobe® Acrobat® Reader software or any other applications software licensed to you by third parties that is included on the same media as Palm Computing's Software ("Other Software") if the Other Software provides that the use of the Other Software is subject to the terms and conditions of the third party's license agreement.

**NO ASSIGNMENT; NO REVERSE ENGINEERING:** You may transfer the Software and this License Agreement to another party if the other party agrees in writing to accept the terms and conditions of this License Agreement. If you transfer the Software, you must at the same time either transfer all copies of the Software as well as the supporting documentation to the same party or destroy any such materials not transferred. Except as set forth above, you may not transfer or assign the Software or your rights under this License Agreement.

Modification, reverse engineering, reverse compiling, or disassembly of the Software is expressly prohibited. However, if you are a European Union ("EU") resident, information necessary to achieve interoperability of the Software with other programs within the meaning of the EU Directive on the Legal Protection of Computer Programs is available to you from Palm Computing upon written request.

**EXPORT RESTRICTIONS:** You agree that you will not export or re-export the Software or accompanying documentation (or any copies thereof) or any products utilizing the Software or such documentation in violation of any applicable laws or regulations of the United States or the country in which you obtained them.

The software covered by this agreement may contain strong data encryption code which cannot be exported outside of the U.S. or Canada. You agree that you will not export/reexport, either physically or electronically, the encryption software or accompanying documentation without obtaining written authorization from the U.S. Department of Commerce.

**TRADE SECRETS; TITLE:** You acknowledge and agree that the structure, sequence and organization of the Software are the valuable trade secrets of Palm Computing and

its suppliers. You agree to hold such trade secrets in confidence. You further acknowledge and agree that ownership of, and title to, the Software and all subsequent copies thereof regardless of the form or media are held by Palm Computing and its suppliers.

**UNITED STATES GOVERNMENT LEGEND:** The Software is commercial in nature and developed solely at private expense. The Software is delivered as "Commercial Computer Software" as defined in DFARS 252.227-7014 (June 1995) or as a commercial item as defined in FAR 2.101(a) and as such is provided with only such rights as are provided in this License Agreement, which is Palm Computing's standard commercial license for the Software. Technical data is provided with limited rights only as provided in DFAR 252.227-7015 (Nov. 1995) or FAR 52.227-14 (June 1987), whichever is applicable.

**TERM AND TERMINATION:** This License Agreement is effective until terminated. You may terminate it at any time by destroying the Software and documentation together with all copies and merged portions in any form. It will also terminate immediately if you fail to comply with any term or condition of this License Agreement. Upon such termination you agree to destroy the Software and documentation, together with all copies and merged portions in any form.

**GOVERNING LAW:** This License Agreement shall be governed by the laws of the State of California and by the laws of the United States, excluding their conflicts of laws principles. The United Nations Convention on Contracts for the International Sale of Goods (1980) is hereby excluded in its entirety from application to this License Agreement.

**LIMITED WARRANTY; LIMITATION OF LIABILITY:** All warranties and limitations of liability applicable to the Software are as stated on the Limited Warranty Card or in the product manual accompanying the Software. Such warranties and limitations of liability are incorporated herein in their entirety by this reference.

**SEVERABILITY:** In the event any provision of this License Agreement is found to be invalid, illegal or unenforceable, the validity, legality and enforceability of any of the remaining provisions shall not in any way be affected or impaired and a valid, legal and enforceable provision of similar intent and economic impact shall be substituted therefor.

**ENTIRE AGREEMENT:** This License Agreement sets forth the entire understanding and agreement between you and Palm Computing, supersedes all prior agreements, whether written or oral, with respect to the Software, and may be amended only in a writing signed by both parties.

Palm Computing, Inc.  
5400 Bayfront Plaza  
PO Box 58007  
Santa Clara, California 95052-8007  
United States of America  
(408) 326-5000  
September 22, 1999

# Safety Statement

**Warning:** Prolonged or improper use of the keyboard may result in discomfort or injury.

You should use the method of inputting data into your Palm Computing® organizer that is most comfortable for you. You may use this keyboard or purchase any of several shapes of styli from Palm Computing or third party accessory providers.

The keyboard is not intended for extended or intensive use. If discomfort develops, consider changing your method of input or the manner in which you use the keyboard or stylus. If discomfort or pain persists, either decrease usage or consult a medical or ergonomics professional.

## FCC Statement

This device complies with part 15 of the FCC rules. Operation is subject to the following two conditions: (1) This device may not cause harmful interference, and (2) this device must accept any interference received, including interference that may cause undesired operation.

**Note:** This equipment has been tested and found to comply with the limits for a Class B digital device, pursuant to Part 15 of the FCC rules. These limits are designed to provide reasonable protection against harmful interference in a residential installation. This equipment generates, uses, and can radiate radio frequency energy and, if not installed and used in accordance with the instructions, may cause harmful interference to radio communications. However, there is no guarantee that interference will not occur in a particular installation. If this equipment does cause harmful interference to radio or television reception, which can be determined by turning the equipment off and on, the user is encouraged to try to correct the interference by one or more of the following measures:

- Reorient or relocate the receiving antenna.
- Increase the separation between the equipment and receiver.
- Connect the equipment into an outlet on a circuit different from that to which the receiver is connected.
- Consult the dealer or an experienced radio/TV technician for help.

The use of shielded I/O cables is required when connecting this equipment to any and all optional peripheral or host devices. Failure to do so may violate FCC rules.

**Caution:** Changes or modifications not covered in this manual must be approved in writing by the manufacturer's Regulatory Engineering Department. Changes or modifications made without written approval may void the user's authority to operate this equipment.

**Responsible Party:**  
**Think Outside, Inc.**  
337 S. Cedros Ave., Suite G  
Solano Beach, CA 92075  
(858) 793-2900

**Palm™ Portable Keyboard**



**Tested to Comply  
With FCC Standards**

**FOR HOME OR OFFICE USE**

## Canadian ICES-003 Statement

This Class B digital apparatus meets all of the requirements of the Canadian Interference-Causing Equipment Regulations.

Cet appareil numérique de la classe B respecte toutes les exigences du Règlement sur le matériel brouilleur du Canada.



## CE Compliance Statement

This product was tested and found to comply with all the requirements of the EMC Directive 89/336/EEC as amended.



This is a Class B product based on the standard of the Voluntary Control Council for Interference from Information Technology Equipment (VCCI). If this is used near a radio or television receiver in a domestic environment, it may cause radio interference. Install and use the equipment according to the instruction manual.

この装置は、情報処理装置等電波障害自主規制協議会（V C C I）の基準に基づくクラスB情報技術装置です。この装置は、家庭環境で使用することを目的としていますが、この装置がラジオやテレビジョン受信機に近接して使用されると、受信障害を引き起こすことがあります。

取扱説明書に従って正しい取り扱いをして下さい。